

PART NUMBER

QM1926C

Customer		WRITTEN BY	
Date	17/07/06	CHECKED BY	PIZQ
Importance Point		APPROVAL BY	

1.0 ELECTRICAL SPECIFICATION

ITEMS	CH 1	CH 2	CH 3	CH 4	UNIT	
1.1 Center Frequency [fo]	1760.0	1855.0	1950.0	2140.0	MHz	
1.2 Bandwidth [BW]	fo± 25.0 [ 1735.0 ~ 1785.0 ]	fo± 25.0 [ 1830.0 ~ 1880.0 ]	fo± 30.0 [ 1920.0 ~ 1980.0 ]	fo± 30.0 [ 2110.0 ~ 2170.0 ]	MHz	
1.3 Insertion Loss in BW	2.7 全温 3.0	2.7 全温 3.0	3.0 全温 3.3	3.0 全温 3.3	dB max.	
1.4 Ripple in BW	1.0	1.0	1.3	1.2	dB max.	
1.5 Return Loss in BW	<input type="checkbox"/> ANT Port				dB min.	
1.6 V S W R in BW	<input checked="" type="checkbox"/> ALL Port	16.0	16.0	16.0	max.	
1.7 Attenuation	<input checked="" type="checkbox"/> Absolute Value	25 dBc min. @ [ DC ~ 800.0 ]	25 dBc min. @ [ DC ~ 800.0 ]	25 dBc min. @ [ DC ~ 800.0 ]	25 dBc min. @ [ DC ~ 800.0 ]	MHz
	<input checked="" type="checkbox"/> Absolute Value	50 dBc min. @ [ 800.0 ~ 960.0 ]	38 dBc min. @ [ 800.0 ~ 960.0 ]	50 dBc min. @ [ 800.0 ~ 960.0 ]	50 dBc min. @ [ 800.0 ~ 960.0 ]	MHz
	<input type="checkbox"/> Relative Value	24 dBc min. @ [ 1000.0 ~ 1690.0 ]	30 dBc min. @ [ 1000.0 ~ 1710.0 ]	30 dBc min. @ [ 1000.0 ~ 1710.0 ]	30 dBc min. @ [ 1000.0 ~ 1710.0 ]	MHz
	<input type="checkbox"/> Relative Value	7 dBc min. @ [ 1805.0 ~ 1920.0 ]	37 dBc min. @ [ 1710.0 ~ 1785.0 ]	40 dBc min. @ [ 1710.0 ~ 1785.0 ]	50 dBc min. @ [ 1710.0 ~ 1785.0 ]	MHz
	<input type="checkbox"/> Relative Value	40 dBc min. @ [ 1920.0 ~ 1980.0 ]	30 dBc min. @ [ 1920.0 ~ 1980.0 ]	47 dBc min. @ [ 1805.0 ~ 1880.0 ]	40 dBc min. @ [ 1805.0 ~ 1880.0 ]	MHz
	<input type="checkbox"/> Relative Value	40 dBc min. @ [ 2010.0 ~ 2025.0 ]	40 dBc min. @ [ 2010.0 ~ 2025.0 ]	2 dBc min. @ [ 2010.0 ~ 2025.0 ]	55 dBc min. @ [ 1880.0 ~ 1980.0 ]	MHz
	<input type="checkbox"/> Relative Value	38 dBc min. @ [ 2110.0 ~ 2170.0 ]	40 dBc min. @ [ 2110.0 ~ 2170.0 ]	50 dBc min. @ [ 2110.0 ~ 2170.0 ]	50 dBc min. @ [ 2010.0 ~ 2025.0 ]	MHz
	<input type="checkbox"/> Relative Value	30 dBc min. @ [ 2170.0 ~ 2300.0 ]	40 dBc min. @ [ 2320.0 ~ 2370.0 ]	30 dBc min. @ [ 2170.0 ~ 2300.0 ]	40 dBc min. @ [ 2320.0 ~ 2370.0 ]	MHz
	<input type="checkbox"/> Relative Value	35 dBc min. @ [ 2320.0 ~ 2370.0 ]	35 dBc min. @ [ 2400.0 ~ 2485.0 ]	40 dBc min. @ [ 2320.0 ~ 2370.0 ]	40 dBc min. @ [ 2400.0 ~ 2485.0 ]	MHz
	<input type="checkbox"/> Relative Value	30 dBc min. @ [ 2400.0 ~ 2485.0 ]	15 dBc min. @ [ 2500.0 ~ 2690.0 ]	38 dBc min. @ [ 2400.0 ~ 2485.0 ]	30 dBc min. @ [ 2500.0 ~ 2690.0 ]	MHz
	<input type="checkbox"/> Relative Value	10 dBc min. @ [ 2500.0 ~ 2690.0 ]	20 dBc min. @ [ 3300.0 ~ 3600.0 ]	20 dBc min. @ [ 2500.0 ~ 2690.0 ]	10 dBc min. @ [ 3300.0 ~ 3600.0 ]	MHz
	<input type="checkbox"/> Relative Value	dBc min. @ [ ~ ]	20 dBc min. @ [ 3660.0 ~ 3700.0 ]	10 dBc min. @ [ 3300.0 ~ 3600.0 ]	20 dBc min. @ [ 4260.0 ~ 4340.0 ]	MHz
	<input type="checkbox"/> Relative Value	dB min. @ [ ~ ]	dB min. @ [ ~ ]	dB min. @ [ ~ ]	dB min. @ [ ~ ]	MHz
<input type="checkbox"/> Relative Value	dB min. @ [ ~ ]	dB min. @ [ ~ ]	dB min. @ [ ~ ]	dB min. @ [ ~ ]	MHz	
1.8 Isolation	CH1---CH2	40 dB min@1735-1785MHz/1830-1880MHz/28dB min@1785-1830MHz			MHz	
	CH3---CH4	57dB min@1920-1980MHz/45dB min@2110-2170MHz/30dB min@1980-2110MHz			MHz	
	CH1---CH3	45 dB min@1735-1785MHz@1920-1980MHz/30dB min@1785-1920MHz			MHz	
	CH1---CH4	50 dB min@1735-1785MHz /45dB min@2110-2170MHz/30dB min@1785-2110MHz			MHz	
	CH2---CH3	45 dB min@1830-1880MHz/ 37dB min@1920-1980MHz/30dB min@1880-1920MHz			MHz	
	CH2---CH4	45 dB min@1830-1880MHz/ 45dB min@2110-2170MHz/30dB min@1880-2110MHz			MHz	
1.9 Coupling					dB	
1.10 Input Power			5.0		W max.	
1.11 In/Out Impedance			50		Ω	
1.12 Operation Temperature Range			-40℃ to +85℃		℃	

2.MECHANICAL SPECIFICATION

Parameter			Comment
Dimensions (W*D*H)	(mm)		
	(inch)		

### TOP VIEW

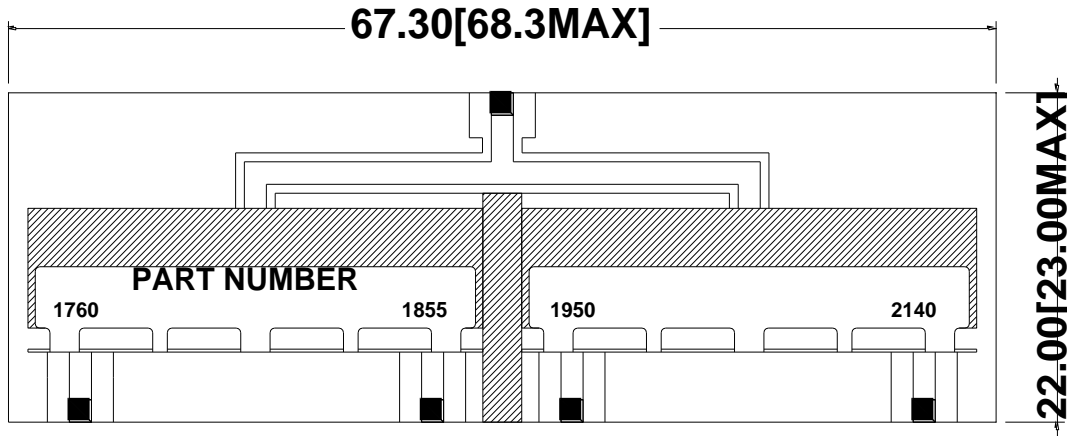

### SIDE VIEW

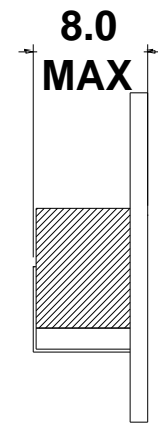

### BOTTOM VIEW

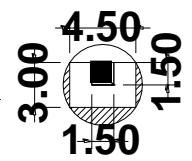
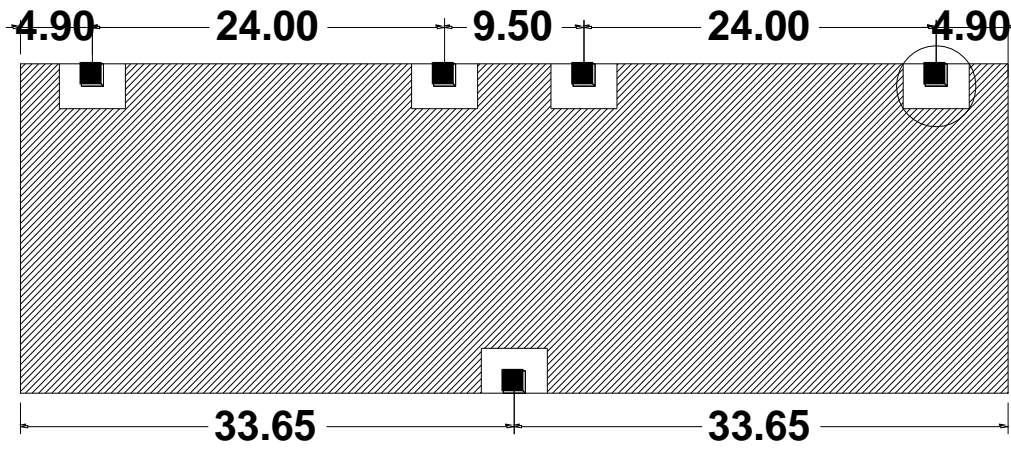

 I/O PORT

 GROUND

TOLERANCE :  $\pm 0.20$

UNIT: mm